



JOIN THESE RETAILERS



Giant™



McWilliams
Ballard

HYATT™

4,436 2ND GEN. RESTAURANT SPACE WITH LARGE PATIO

- Turn-key space with all FF&E in place.
- Join a mixed-use project with 717 apartments and 182 key hotel
- Dedicated building ownership: **ROADSIDE**

JENN PRICE

jprice@klnb.com | 202-420-7768

KIM STEIN

kstein@klnb.com | 202-652-2338

KELLY ATKINSON

katkinson@klnb.com | 202-420-7762

LOCATION CITY MARKET AT O

1400 7TH ST NW, WASHINGTON, DC 20001

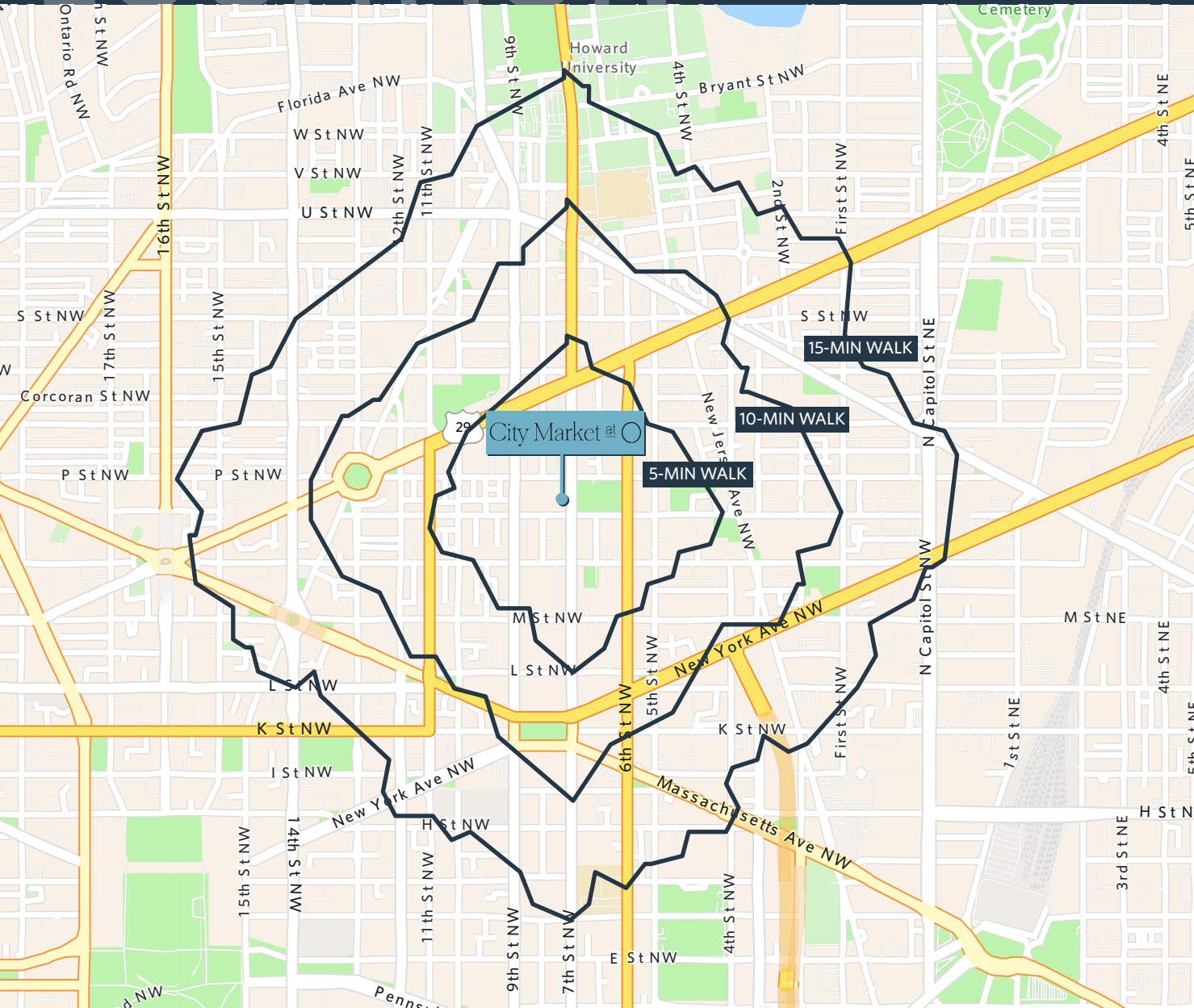

DEMOGRAPHICS | 2024:

WALK TIME:

5-MIN

10-MIN

15-MIN

Population

6,291

20,419

47,519

Daytime Population

2,700

16,660

57,917

Households

3,199

10,851

27,062

Average HH Income

\$161,889

\$194,108

\$181,330

[CLICK TO DOWNLOAD DEMOGRAPHIC REPORT](#)

THE NEIGHBORHOOD:

AMBAR SHAW

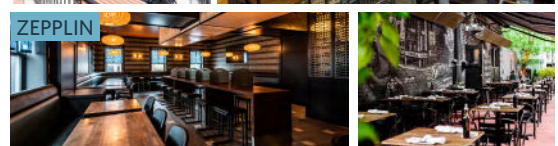
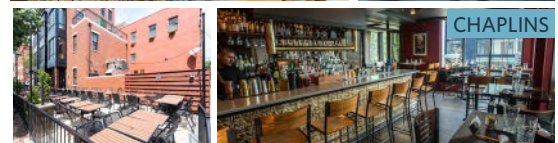

JENN PRICE

jprice@klnb.com | 202-420-7768

KIM STEIN

kstein@klnb.com | 202-652-2338

KELLY ATKINSON

katkinson@klnb.com | 202-420-7762

klnb

MARKET

CITY MARKET AT O

1400 7TH ST NW, WASHINGTON, DC 20001



JENN PRICE

jprice@klnb.com | 202-420-7768

KIM STEIN

kstein@klnb.com | 202-652-2338

KELLY ATKINSON

katkinson@klnb.com | 202-420-7762

klnb

P STREET NW

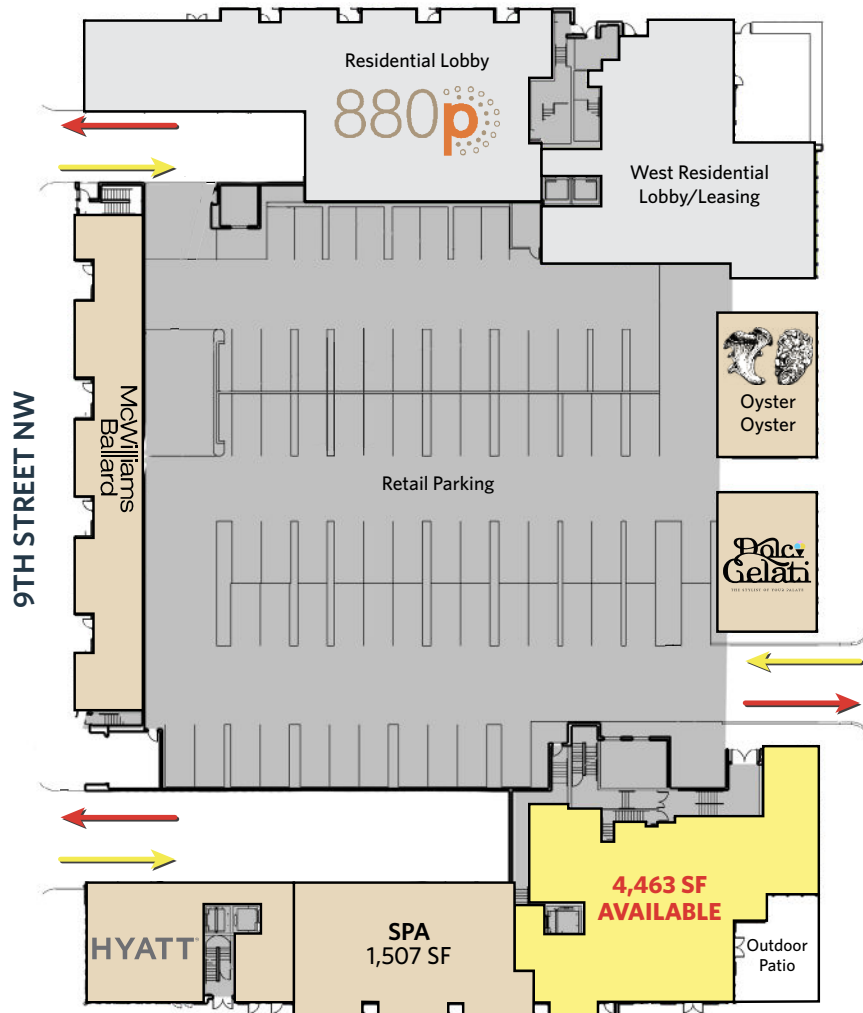

8TH STREET NW



7TH STREET NW

O STREET NW

JENN PRICE

jprice@klnb.com | 202-420-7768

KIM STEIN

kstein@klnb.com | 202-652-2338

KELLY ATKINSON

katkinson@klnb.com | 202-420-7762



CITY MARKET AT O

1400 7TH ST NW, WASHINGTON, DC 20001

FOR MORE INFORMATION, PLEASE CONTACT:

JENN PRICE

jprice@klnb.com

202-420-7768

KIM STEIN

kstein@klnb.com

202-652-2338

KELLY ATKINSON

katkinson@klnb.com

202-420-7762

1130 Connecticut Ave, NW, Suite 600, Washington, DC 20036

.....

klnb.com



[instagram.com/klnbcre](https://www.instagram.com/klnbcre)



[linkedin.com/company/klnb](https://www.linkedin.com/company/klnb)



[facebook.com/KLNBCRE](https://www.facebook.com/KLNBCRE)

CLICK TO VIEW PROPERTY WEBSITE

While we have no reason to doubt the accuracy of any of the information supplied, we cannot, and do not, guarantee its accuracy. All information should be independently verified prior to a purchase or lease of the property. We are not responsible for errors, omissions, misuse, or misinterpretation of information contained herein and make no warranty of any kind, express or implied, with respect to the property or any other matters.